

4

3

2

1

# CROWN LINK<sup>®</sup>

專業薄膜開關連接器第一品牌

ROHS

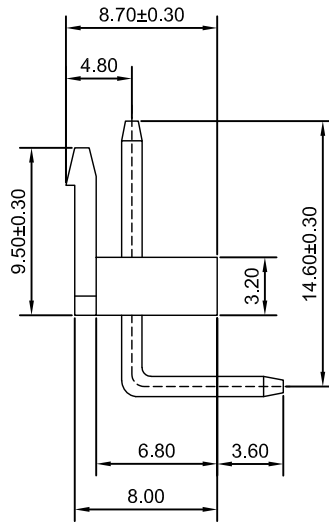
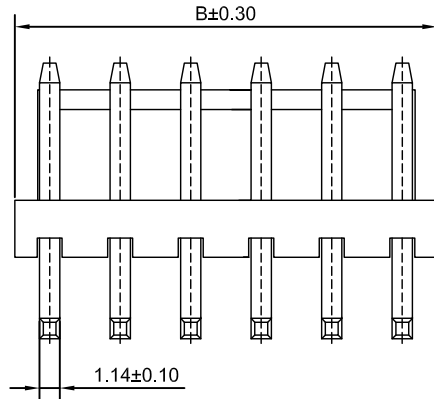

- ◆ FOR 3961HL HOUSING
- ◆ SPECIFICATIONS
  - VOLTAGE RATING: 250V AC, DC
  - CURRENT RATING: 7A AC, DC
  - CONTACT RESISTANCE: 20 mΩ MAX
  - INSULATION RESISTANCE: 1000 MΩ MIN
  - WITHSTANDING VOLTAGE: 1500V AC / MINUTE
- ◆ ENVIRONMENTAL
  - TEMPERATURE RANGE: -25°C ~ +85°C
- ◆ PART NO.

CL3961 R - XX N H

ANGLE 90° NO LOGO MOLD NO. SERIES NO. CIRCUITS NUMBER 02 TO 12

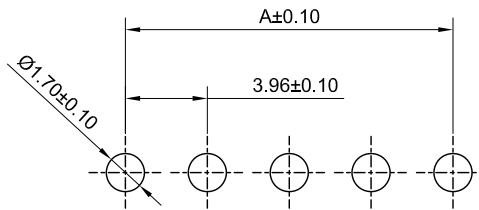
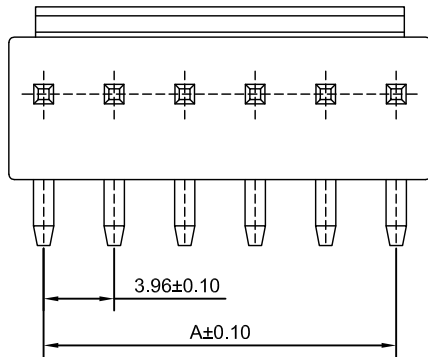

P.C.B LAYOUT

Part NO.	Dimensions		Part NO.	Dimensions	
	A	B		A	B
02	3.96	7.92	08	27.72	31.68
03	7.92	11.88	09	31.68	35.64
04	11.88	15.84	10	35.64	39.60
05	15.84	19.80	11	39.60	43.56
06	19.80	23.76	12	43.56	47.52
07	23.76	27.72			

REV/版本	MODIFIED CONTENT /變更內容	DRAWN/繪圖	DATE/日期	TOLERANCE RANGE/公差範圍
				X. ±0.50 X." ±3° X ±0.30 X' ±2° .XX ±0.20 .XX' ±1° .XXX ±0.10 .XXX' ±0.5°

DRAWN/繪圖	DATE/日期	<b>CROWN LINK<sup>®</sup> THE LEADING MANUFACTURER OF FPC &amp; FFC CONNECTOR, HOUSING AND DOME.</b>				
JUDY	2024.04.19	PRODUCT NAME/品名 3.96mm PITCH 90° WAFER				
CHECK BY/審查	DATE/日期	PART NO./料號	PIN NUMBER/針數	SCALE/比例	SIZE/圖號	UNIT/單位
VIVIAN	2024.04.19	CL3961R-XXNH	02-12PIN	3:1	A4	mm
APPROVED BY/核准	DATE/日期	MATERIAL/材質	COLOR/顏色	ANGLE OF VIEW/視角	SHEET/頁碼	REV/版本
WENDY	2024.04.19	BRASS TIN	NATURAL	30°	1 OF 1	C
PACKAGE/包裝	2,000PCS/BAG	NY66 UL94V-0				