

CROWN LINK[®]

專業薄膜開關連接器第一品牌

RoHS

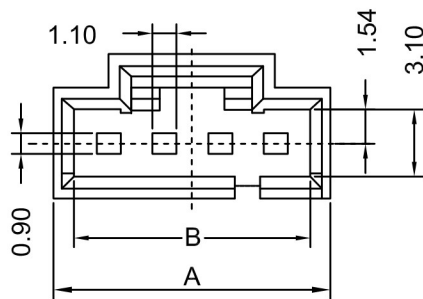
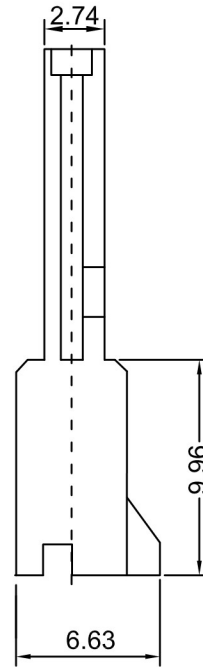
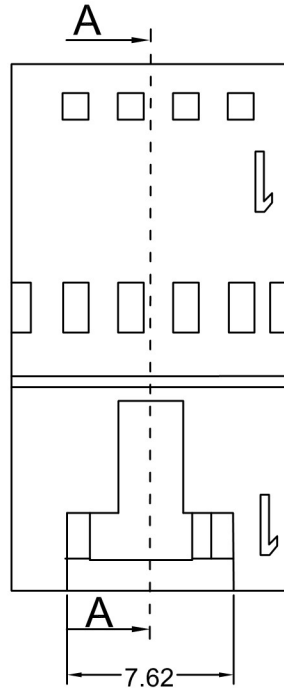

SECTION A-A

- ◆ FOR 2803 SERIES CONNECTOR
- ◆ SPECIFICATIONS
 - VOLTAGE RATING: 300 V AC , DC
 - CURRENT RATING: 2 A
 - INSULATION RESISTANCE: ≥ 500 M Ω MIN
- ◆ ENVIRONMENTAL
 - TEMPERATURE RANGE: -20°C~+85°C
 - WITHSAND VOLTAGE: 1000 V AC / MINUTE

◆ PART NO.
2803HLW - XXCN
 SERIES NO. NO LOGO
 CONCAVE
 CIRCUITS NUMBER 04 TO 05

◆ SPECIFIED TOLERANCE

PIN NO.	A	B
04	12.7	10.90
05	15.24	13.44

A	FIRST DRAWING	MARY	2018.05.22
REV/版本	MODIFIED CONTENT /變更內容	DRAWN/繪圖	DATE/日期

一般公差 ± 0.2
 TOLERANCE RANGE/公差範圍

DRAWN/繪圖	DATE/日期	CROWN LINK[®] THE LEADING MANUFACTURER OF FPC & FFC CONNECTOR, HOUSING AND DOME.				
MARY	2018.05.22	PRODUCT NAME/品名				
CHECK BY/審查	DATE/日期	2.54mm PITCH HOUSING FOR FFC/FPC				
VIVIAN	2018.05.22	PART NO./料號	PIN NUMBER/針數	SCALE/比例	SIZE/圖號	UNIT/單位
APPROVED BY/核准	DATE/日期	2803HLW-XXCN	04-05 PIN	3:1	A4	mm
JASON	2018.05.22	MATERIAL/材質	COLOR/顏色	ANGLE OF VIEW/視角	SHEET/頁碼	REV/版本
PACKAGE/包裝	500 PCS/BAG	PBT UL 94V - 0	BLACK COLOR		1 OF 1	A