

# CROWN LINK®

專業薄膜開關連接器第一品牌

RoHS

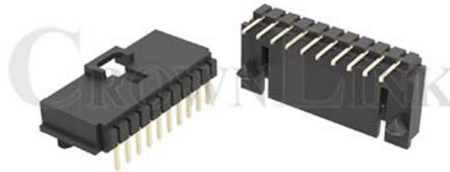

- ◆ SPECIFICATIONS
  - VOLTAGE RATING: 250 V AC, DC
  - CURRENT RATING: 3 A AC, DC
  - INSULATION RESISTANCE: 1000 MΩ MIN
  - WITHSTANDING VOLTAGE: 1500V AC / MINUTE
- ◆ ENVIRONMENTAL
  - TEMPERATURE RANGE: -40°C~+105°C

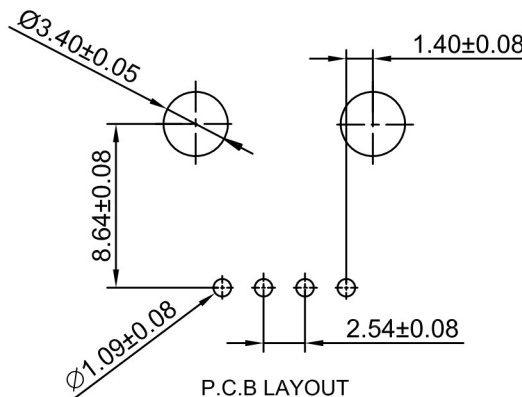
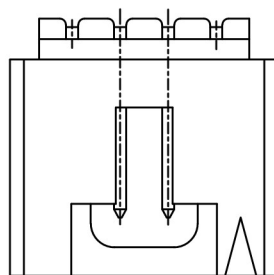

◆ PART NO.

CL2545 R - XX T C N P

ANGLE 90°

MOLD NO.

NO LOGO

COLUMN

TUBE

SERIES NO.      CIRCUITS NUMBER 02 TO 25

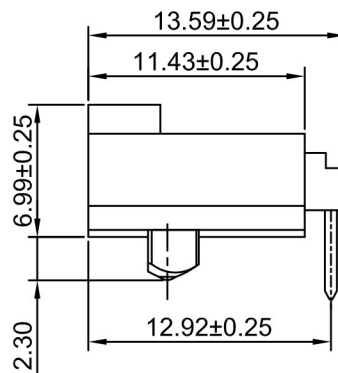
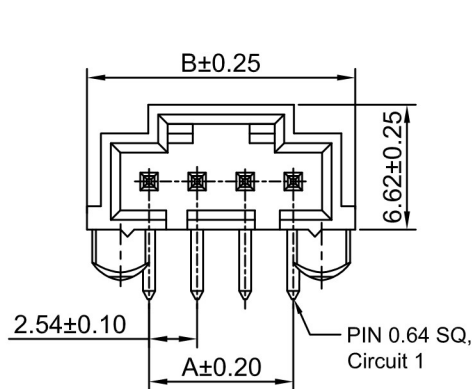

Part NO.	Dimensions		Part NO.	Dimensions	
	A	B		A	B
CL2545R-02TCNP	2.54	8.89	CL2545R-14TCNP	33.02	39.37
CL2545R-03TCNP	5.08	11.43	CL2545R-15TCNP	35.56	41.91
CL2545R-04TCNP	7.62	13.97	CL2545R-16TCNP	38.10	44.45
CL2545R-05TCNP	10.16	16.51	CL2545R-17TCNP	40.64	46.99
CL2545R-06TCNP	12.70	19.05	CL2545R-18TCNP	43.18	49.53
CL2545R-07TCNP	15.24	21.59	CL2545R-19TCNP	45.72	52.07
CL2545R-08TCNP	17.78	24.13	CL2545R-20TCNP	48.26	54.61
CL2545R-09TCNP	20.32	26.67	CL2545R-21TCNP	50.80	57.15
CL2545R-10TCNP	22.86	29.21	CL2545R-22TCNP	53.34	59.69
CL2545R-11TCNP	25.40	31.75	CL2545R-23TCNP	55.88	62.23
CL2545R-12TCNP	27.94	34.29	CL2545R-24TCNP	58.42	64.77
CL2545R-13TCNP	30.98	36.83	CL2545R-25TCNP	60.96	67.31

				X. $\pm 0.35$
				X.X $\pm 0.25$
A	FIRST DRAWING	LACY	2020.04.21	X.XX $\pm 0.20$
REV/版本	MODIFIED CONTENT /變更內容	DRAWN/繪圖	DATE/日期	X.XXX $\pm 0.15$
				TOLERANCE RANGE/公差範圍

DRAWN/繪圖	DATE/日期
LACY	2020.04.21
CHECK BY/審查	DATE/日期
VIVIAN	2020.04.21
APPROVED BY/核准	DATE/日期
WENDY	2020.04.21
PACKAGE/包裝	TUBE

<b>CROWN LINK® THE LEADING MANUFACTURER OF FPC &amp; FFC CONNECTOR, HOUSING AND DOME.</b>				
PRODUCT NAME/品名				
2.54mm PITCH 90° WAFER				
PART NO./料號	PIN NUMBER/針數	SCALE/比例	SIZE/圖號	UNIT/單位
CL2545R-XXTCNP	2-25 PIN	2.5:1	A4	mm
MATERIAL/材質	COLOR/顏色	ANGLE OF VIEW/視角	SHEET/頁碼	REV/版本
PBT UL 94V-0	BLACK COLOR		1 OF 1	A