

4

3

2

1

CROWN LINK[®]

專業薄膜開關連接器第一品牌

RoHS

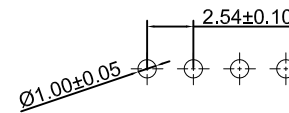
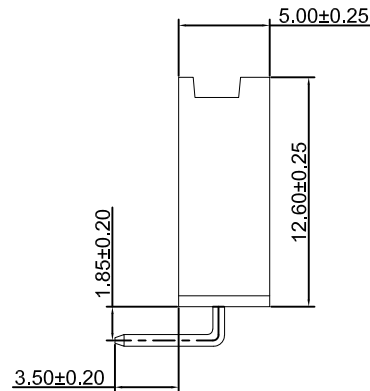
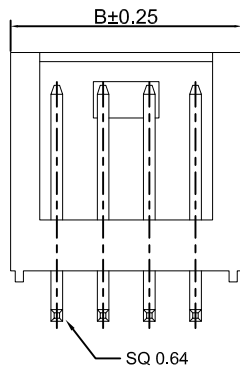
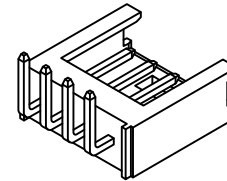
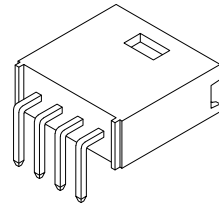
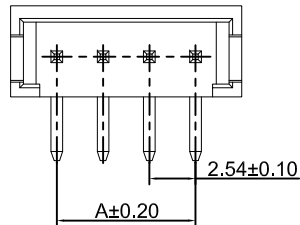

P.C.B LAYOUT

◆ SPECIFICATIONS

VOLTAGE RATING: 250 V AC , DC

CURRENT RATING: 3 A AC , DC

CONTACT RESISTANCE: 20 mΩ MAX

INSULATION RESISTANCE: 1000 MΩ MIN

WITHSTANDING VOLTAGE: 1000V AC / MINUTE

◆ ENVIRONMENTAL

TEMPERATURE RANGE: -40°C~+105°C

◆ PART NO.

CL2543 R - XX N P

ANGLE 90°

MOLD NO.
NO LOGO

SERIES NO.

CIRCUITS NUMBER 02 TO 22

Part NO.	Dimensions		Part NO.	Dimensions	
	A	B		A	B
CL2543R-02NP	2.54	7.62	CL2543R-13NP	30.48	35.56
CL2543R-03NP	5.08	10.16	CL2543R-14NP	33.02	38.10
CL2543R-04NP	7.62	12.70	CL2543R-15NP	35.56	40.64
CL2543R-05NP	10.16	15.24	CL2543R-16NP	38.10	43.18
CL2543R-06NP	12.70	17.78	CL2543R-17NP	40.64	45.72
CL2543R-07NP	15.24	20.32	CL2543R-18NP	43.18	48.26
CL2543R-08NP	17.78	22.86	CL2543R-19NP	45.72	50.80
CL2543R-09NP	20.32	25.40	CL2543R-20NP	48.26	53.34
CL2543R-10NP	22.86	27.94	CL2543R-21NP	50.80	55.88
CL2543R-11NP	25.40	30.48	CL2543R-22NP	53.34	58.42
CL2543R-12NP	27.94	33.02			

REV/版本	MODIFIED CONTENT /變更內容	DRAWN/繪圖	DATE/日期	TOLERANCE RANGE/公差範圍
				X. ±0.50 X." ±1° .X ±0.30 .X" ±0.1° .XX ±0.20 .XX" ±0.01° .XXX ±0.05 .XXX" ±0.005°

DRAWN/繪圖	DATE/日期
JDUY	2023.05.22
CHECK BY/審查	DATE/日期
VIVIAN	2023.05.22
APPROVED BY/核淮	DATE/日期
WENDY	2023.05.22
PACKAGE/包裝	BAG

CROWN LINK [®] THE LEADING MANUFACTURER OF FPC & FFC CONNECTOR, HOUSING AND DOME.					
PRODUCT NAME/品名					
2.54mm PITCH 90° WAFER					
PART NO./料號	PIN NUMBER/針數	SCALE/比例	SIZE/圖號	UNIT/單位	
CL2543R-XXNP	2-22 PIN	2.5:1	A4	mm	
MATERIAL/材質	COLOR/顏色	ANGLE OF VIEW/視角	SHEET/頁碼	REV/版本	
PBT UL 94V-0 BRASS/TIN	BLACK COLOR		1 OF 1	A	