

4

3

2

1

CROWN LINK[®]

專業薄膜開關連接器第一品牌

RoHS

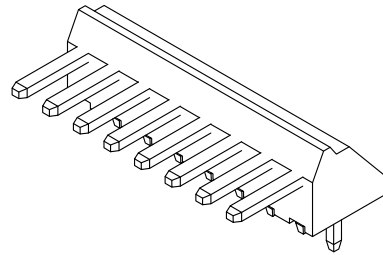
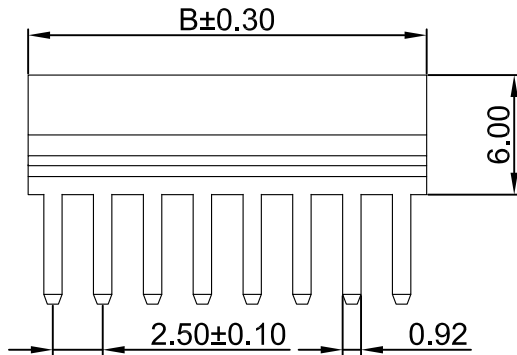

- ◆ FOR 2502H HOUSING
- ◆ SPECIFICATIONS
 - VOLTAGE RATING: 250V AC, DC
 - CURRENT RATING: 3 A AC,DC
 - CONTACT RESISTANCE: 20mΩ MAX
 - INSULATION RESISTANCE: 1000 MΩ MIN
 - WITHSTANDING VOLTAGE: 1000V AC / MINUTE

- ◆ ENVIRONMENTAL
 - TEMPERATURE RANGE: -25°C~+85°C

◆ PART NO.

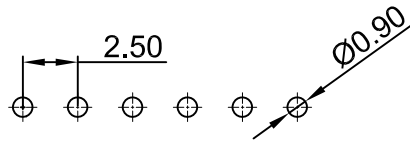
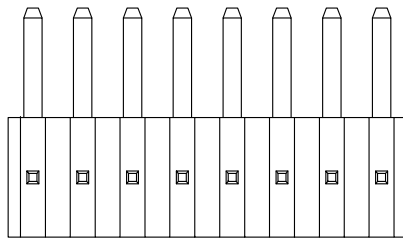
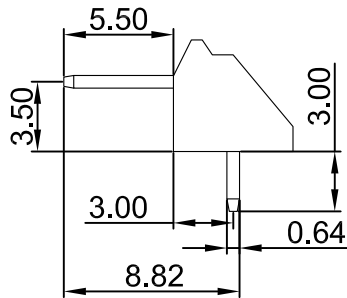
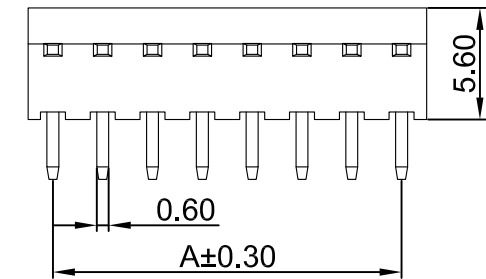
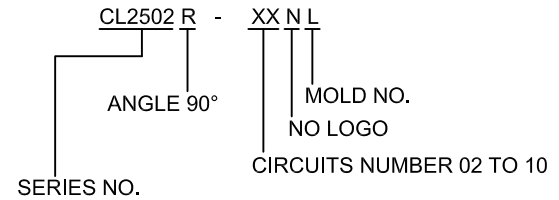

P.C.B LAYOUT

Part NO.	Dimensions	
	A	B
02	2.50	5.00
03	5.00	7.50
04	7.50	10.00
05	10.00	12.50
06	12.50	15.00
07	15.00	17.50
08	17.50	20.00
09	20.00	22.50
10	22.50	25.00

REV/版本	MODIFIED CONTENT /變更內容	DRAWN/繪圖	DATE/日期

TOLERANCE RANGE/公差範圍
X: ±0.50 X*: ±1" X: ±0.30 X*: ±0.1" .XX ±0.20 .XX*: ±0.01" .XXX ±0.05 .XXX*: ±0.005"

DRAWN/繪圖 JUDY	DATE/日期 2023.07.17	CROWN LINK[®] THE LEADING MANUFACTURER OF FPC & FFC CONNECTOR, HOUSING AND DOME. PRODUCT NAME/品名 2.5mm XHB Wafer for Cable				
CHECK BY/審查 VIVIAN	DATE/日期 2023.07.17					
APPROVED BY/核准 JASON	DATE/日期 2023.07.17	PART NO./料號 CL2502R-XXNL	PIN NUMBER/針數 02-10 PIN	SCALE/比例 3:1	SIZE/圖號 A4	UNIT/單位 mm
PACKAGE/包裝 BAG		MATERIAL/材質 BRASS/TIN PA66 UL94V-0	COLOR/顏色 NATURAL	ANGLE OF VIEW/視角 	SHEET/頁碼 1 OF 1	REV/版本 D

D

D

C

C

B

B

A

A