

4

3

2

1

CROWN LINK®

專業薄膜開關連接器第一品牌

ROHS

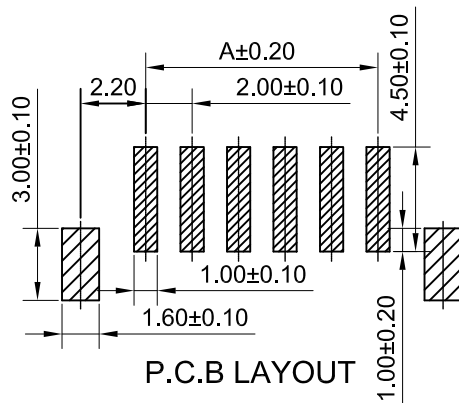
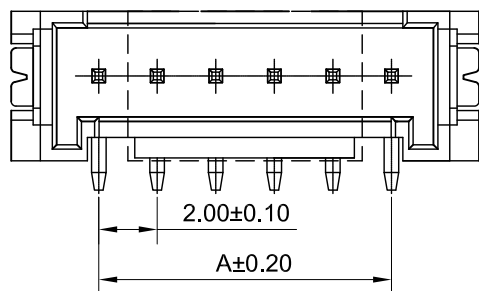
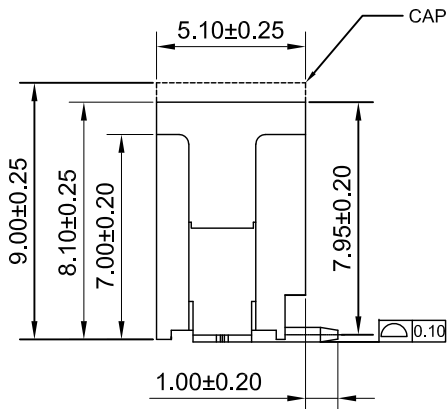
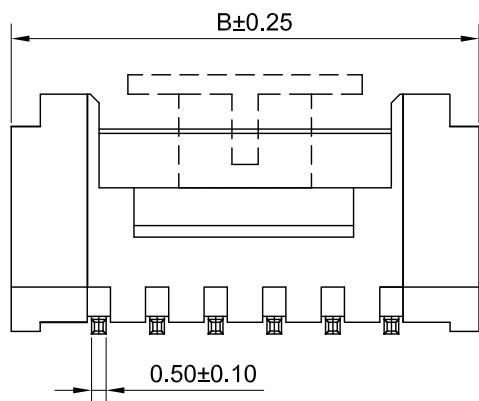

- ◆ FOR 2005HL HOUSING
- ◆ SPECIFICATIONS
 - VOLTAGE RATING: 250V AC,DC
 - CURRENT RATING: 2A AC,DC
 - CONTACT RESISTANCE: 20 mΩ MAX
 - INSULATION RESISTANCE: 1000 MΩ MIN
 - WITHSTANDING VOLTAGE: 1000V AC / MINUTE
- ◆ ENVIRONMENTAL
 - TEMPERATURE RANGE: -25°C~+85°C
- ◆ PART NO.

CL2005 S	-	XX	V	N	H
SMT					MOLD NO.
					NO LOGO
					VERTICAL

SERIES NO. CIRCUITS NUMBER 02 TO 12 OR 20

Part NO.	Dimensions	
	A	B
02	2.00	8.00
03	4.00	10.00
04	6.00	12.00
05	8.00	14.00
06	10.00	16.00
07	12.00	18.00
08	14.00	20.00
09	16.00	22.00
10	18.00	24.00
11	20.00	26.00
12	22.00	28.00
20	38.00	44.00

REV/版本	MODIFIED CONTENT /變更內容	DRAWN/繪圖	DATE/日期	TOLERANCE RANGE/公差範圍
				X .±0.50 X.* ±3° X ±0.30 X.* ±2° .XX ±0.20 .XX.* ±1° .XXX ±0.10 .XXX.* ±0.5°

DRAWN/繪圖 JUDY	DATE/日期 2023.08.25	CROWN LINK® THE LEADING MANUFACTURER OF FPC & FFC CONNECTOR, HOUSING AND DOME.				
CHECK BY/審查 VIVIAN	DATE/日期 2023.08.25					
APPROVED BY/核准 JASON	DATE/日期 2023.08.25	PART NO./料號 CL2005S-XXVNH	PIN NUMBER/針數 02-12OR20 PIN	SCALE/比例 5:1	SIZE/圖號 A4	UNIT/單位 mm
PACKAGE/包裝	600PCS/REEL	MATERIAL/材質 BRASS TIN LCP UL94V-0	COLOR/顏色 NATURAL	ANGLE OF VIEW/視角 	SHEET/頁碼 1 OF 1	REV/版本 A