

4

3

2

1

CROWN LINK®

專業薄膜開關連接器第一品牌

ROHS

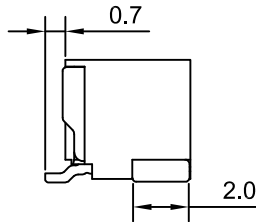
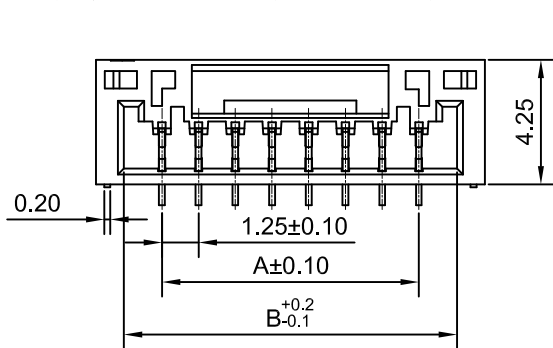

- ◆ FOR 1254HL HOUSING
- ◆ SPECIFICATIONS
 - VOLTAGE RATING: 50V AC,DC
 - CURRENT RATING: 1A AC,DC
 - CONTACT RESISTANCE: 20 mΩ MAX
 - INSULATION RESISTANCE: 100 MΩ MIN
 - WITHSTANDING VOLTAGE: 500V AC / MINUTE
- ◆ ENVIRONMENTAL
 - TEMPERATURE RANGE: -25°C~+85°C

◆ PART NO.
 CL1254 S - XX V N H
 SMT MOLD NO.
 NO LOGO
 VERTICAL
 SERIES NO. CIRCUITS NUMBER 02 TO 15

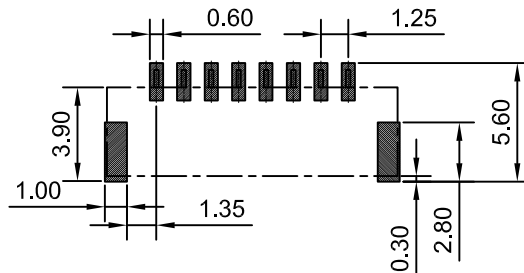
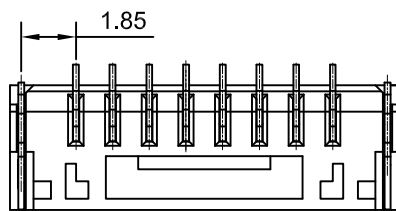
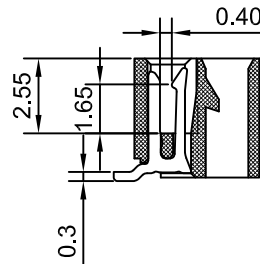
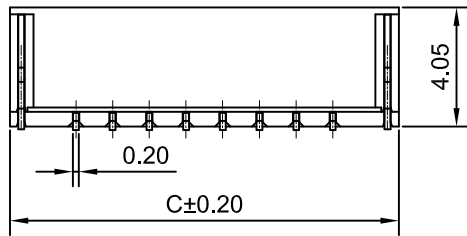

P.C.B LAYOUT

Part NO.	Dimensions			Part NO.	Dimensions		
	A	B	C		A	B	C
02	1.25	3.85	5.75	09	10.00	12.60	14.50
03	2.50	5.10	7.00	10	11.25	13.85	15.75
04	3.75	6.35	8.25	11	12.50	15.10	17.00
05	5.00	7.60	9.50	12	13.75	16.35	18.25
06	6.25	8.85	10.75	13	15.00	17.60	19.50
07	7.50	10.10	12.00	14	16.25	18.85	20.75
08	8.75	11.35	13.25	15	17.50	20.10	22.00

REV/版本	MODIFIED CONTENT /變更內容	DRAWN/繪圖	DATE/日期	TOLERANCE RANGE/公差範圍
				X. ±0.50 X.* ±3° .X ±0.30 .X* ±2° .XX ±0.20 .XX* ±1° .XXX ±0.10 .XXX* ±0.5°

DRAWN/繪圖 JUDY 2023.08.23	DATE/日期 2023.08.23	CROWN LINK® THE LEADING MANUFACTURER OF FPC & FFC CONNECTOR, HOUSING AND DOME.				
CHECK BY/審查 VIVIAN 2023.08.23	DATE/日期 2023.08.23	PRODUCT NAME/品名 1.25mm PITCH SMT WAFER				
APPROVED BY/核准 JASON 2023.08.23	DATE/日期 2023.08.23	PART NO./料號 CL1254S-XXVNH	PIN NUMBER/針數 02-15 PIN	SCALE/比例 5:1	SIZE/圖號 A4	UNIT/單位 mm
PACKAGE/包裝 1,500PCS/REEL		MATERIAL/材質 PHOSPHOR BRONZE TIN PA6T UL94V-0	COLOR/顏色 NATURAL	ANGLE OF VIEW/視角 ⊕	SHEET/頁碼 1 OF 1	REV/版本 A