

4

3

2

1

CROWN LINK[®]

專業薄膜開關連接器第一品牌

ROHS



0T:TIN PLATED

0G:GOLD PLATED

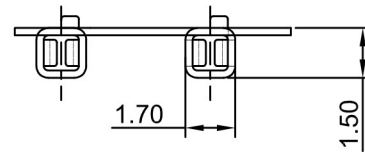

SECTION A-A

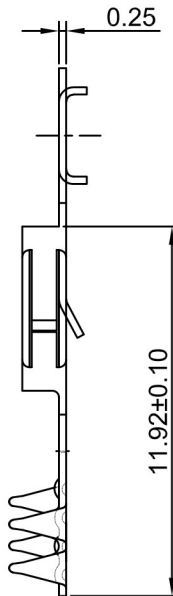
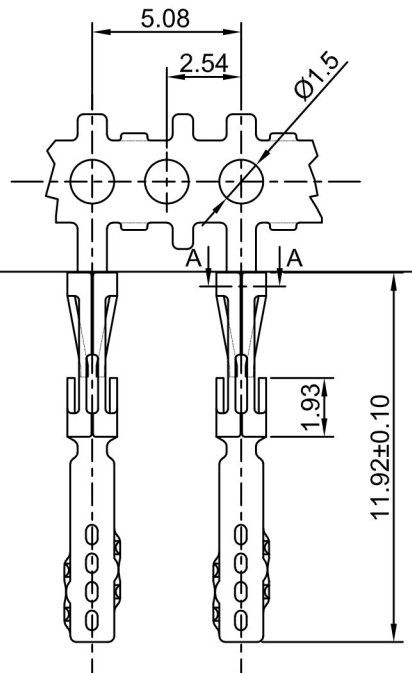

- ◆ FOR 2806 SERIES HOUSING
- ◆ SPECIFICATIONS
 - VOLTAGE RATING: 250 VAC RMS
 - CURRENT RATING: 3 AMP
 - DIELECTRIC WITHSTANDING VOLTAGE: AC 250V FOR 1 MINUTE
 - INSULATION RESISTANCE: 500 MΩ
- ◆ ENVIRONMENTAL
 - TEMPERATURE RANGE: -40°C~+105°C

◆ PART NO.

2806B - 15K - 0T(0G) - FH

SERIES NO.

15K/REEL

FEMALE

MOLD NO.

0T:TIN PLATED
 0G:GOLD PLATED
 OTHER PLATINGS ON REQUEST

cutting

				X. ±0.20
				.X ±0.10
				.XX ±0.05
B	PART NO CHANGE	ANNIE	2013.05.13	
REV/版本	MODIFIED CONTENT /變更內容	DRAWN/繪圖	DATE/日期	TOLERANCE RANGE/公差範圍

DRAWN/繪圖	DATE/日期	CROWN LINK[®] THE LEADING MANUFACTURER OF FPC & FFC CONNECTOR, HOUSING AND DOME.			
ANNIE	2013.05.13	PRODUCT NAME/品名 5.08mm PITCH FFC/FPC CONNECTOR			
CHECK BY/審查	DATE/日期	PART NO./料號	SCALE/比例	SIZE/圖號	UNIT/單位
VIVIAN	2013.05.13	2806B-15K-0T(0G)-FH	4:1	A4	mm
APPROVED BY/核准	DATE/日期	MATERIAL/材質	ANGLE OF VIEW/視角	SHEET/頁碼	REV/版本
JASON	2013.05.13	PHOSPHOR BRONZE	⊕	1 OF 1	B
PACKAGE/包裝	15,000PCS/REEL				

D

C

B

A

D

C

B

A