

4

3

2

1

CROWN LINK[®]

專業薄膜開關連接器第一品牌

ROHS

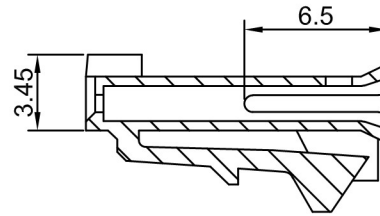

- ◆ FOR 2806 SERIES CONNECTOR
- ◆ SPECIFICATIONS
 - VOLTAGE RATING: 250 VAC RMS
 - CURRENT RATING: 2A
 - INSULATION RESISTANCE: 1000 MΩ MIN
- ◆ ENVIRONMENTAL
 - TEMPERATURE RANGE: -25°C~+85°C

- ◆ DIMENSION: N=CIRCUIT NO.
 - A=2.54*N
 - B=2.54*(N-1)

- ◆ PART NO.
 - 2806HLC - XXNH
 - SERIES NO. | MOLD NO.
 - NO LOGO
 - CIRCUITS NUMBER 02 TO 26

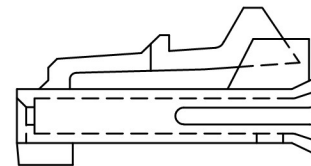
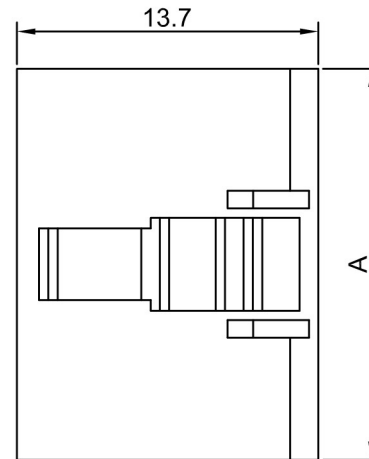
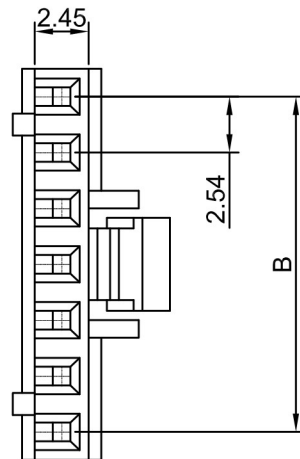
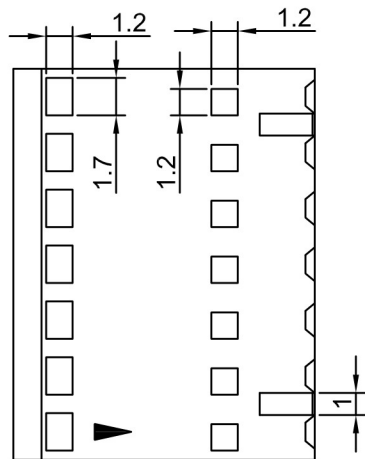

B	PIN NUMBER CHANGE	TRACY	2016.09.22
A	FIRST DRAWING	ANNIE	2013.12.17
REV/版本	MODIFIED CONTENT /變更內容	DRAWN/繪圖	DATE/日期

一般公差 ± 0.2
TOLERANCE RANGE/公差範圍

DRAWN/繪圖	DATE/日期	CROWN LINK[®] THE LEADING MANUFACTURER OF FPC & FFC CONNECTOR, HOUSING AND DOME.				
TRACY	2016.12.22	PRODUCT NAME/品名				
CHECK BY/審查	DATE/日期	2.54mm PITCH HOUSING FOR FFC/FPC				
VIVIAN	2016.12.22	PART NO./料號	PIN NUMBER/針數	SCALE/比例	SIZE/圖號	UNIT/單位
APPROVED BY/核准	DATE/日期	2806HLC-XXNH	2-26 PIN	3:1	A4	mm
JASON	2016.12.22	MATERIAL/材質	COLOR/顏色	ANGLE OF VIEW/視角	SHEET/頁碼	REV/版本
PACKAGE/包裝	02-06 PIN 1,000 PCS/BAG 07-26 PIN 500 PCS/BAG	NYLON 66 UL94V-0	BLACK COLOR	⊕	1 OF 1	B

D

D

C

C

B

B

A

A